

# INNER CIRCLE

Saral, Alibaug

NEW PHASE





## ABOUT US

Step into a world surrounded by a lush expanse that the modern concrete jungle craves! Enjoy the sense of being away from the daily hustle, with amenities that rival the city's best. A gated community that embodies a fresh and minimalistic aesthetic that is spread across 7 acres in the peaceful locality of Saral, Alibaug.

Inner Circle offers a contemporary mix of bespoke villas and condominiums, where privacy meets community, and a harmonious blend prevails.

We're pleased to announce that we're expanding the community with Phase III. Experience the next level of comfort and convenience at Inner Circle, Alibaug

## Key Benefits

Inner Circle offers an experience like no other, with its easy living charm. It also boasts stunning views of lush green landscapes, providing a perfect escape from the fast-paced city life.



A 15-min drive from  
the Mandwa Jetty



Easy accessibility to  
the big city



Multiple  
amenities



Abundance of  
greenery



## LOCATION

A peaceful and exclusive coastal town in the Konkan region, Alibaug is bound on the north and west by the sea. Alibaug and its neighbouring areas are well connected by roads and waterways. The nearest airport is Mumbai or Pune and the nearest railway station is Pen.













# TEAM

Inner Circle is a culmination of a passion realized by those excelling in the service, design, and real estate sectors. Their collective vision has brought to life, Inner Circle, a tranquil escape.



**Sahil Vora**  
**Partner**

Sahil Vora is the Founder of SILA, an integrated platform with Real Estate services, Development and Asset Management. SILA's Development business has a Mumbai Metropolitan Region (MMR) focused strategy and is currently constructing Residential Real Estate of over 500,000 sq. ft.

Prior to the inception of the company, Sahil served as a Financial Analyst at George Weiss Associates, a USD 3 billion hedge fund in New York, USA.



**Harsh Mehta**  
**Partner**

Harsh Mehta is the Director and Managing Director of Top Notch Realty Pvt. Ltd. and High End Developers Pvt. Ltd. Top Notch Realty was founded in 2005, after gaining experience and understanding of the construction business.

His plans include developing various other residential/ hospitality and commercial projects.



**Krishan Kapur**  
**Partner**

Krishan Kapur is the Founder and Managing Director of JCK Group which has successfully developed Industrial Township projects across the country.

Prior to founding JCK, Krishan spent close to a decade at Deutsche Bank as an investment banker. In addition to Inner Circle, Krishan is working on a resort township in Mandwa, Alibaug.

# AMENITIES

Inner Circle offers a variety of amenities to residents to enhance their community-living experience. These may include recreational facilities as well as common areas for socializing.



**Business Center**



**Community Kitchen**



**Community Manager**



**Games Room**



**Gymnasium**



**Library Lounge**



**Massage Room**



**Mini Theatre**



**Multipurpose Court**



**Putting Green**



**Padel Court**



**Swimming Pool**

# PLANS

## New Phase Plan

Inner Circle's New Phase hosts 26 condominiums and 1 bespoke villa that exudes modernity and serenity. Each unit, the open spaces, and the clubhouse are carefully designed to achieve collective harmony while retaining a sense of individuality.

## Condos

Inner Circle's condos make for the perfect place to achieve tranquillity. A contemporary space suffused with an abundance of natural light and a stone's throw away from all the conveniences this community living concept has to offer.

## Villa

Inner Circle's lavish villa offers a complete package of all the comforts and conveniences one could ask for. The villa showcases a blend of contemporary aesthetics while harmonizing perfectly with the nature surrounding them.



## Condos

### Condo E | 3 BHK

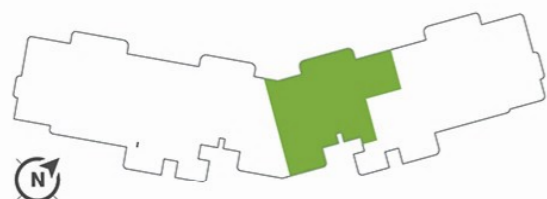

Please Note: The above image is an artist's expression of the floor plan. The areas provided above are approximate, quantifiable by the standard dimension provided.

DIMENSIONS AREA Sq. Ft.

1.	Living Area	28'2" x 16'5"	462
2.	Dining Area	12'0" x 12'9"	153
3.	Kitchen	8'6" x 12'6"	106
4.	Dry Balcony	8'6" x 4'6"	38
5.	Master Bedroom 1	12'0" x 16'5"	196
6.	Master Walk-in	7'0" x 6'8"	46
7.	Master Toilet	7'0" x 9'5"	64
8.	Bedroom 2	12'0" x 16'0"	192
9.	Bedroom 2 Walk-in	8'6" x 7'0"	59
10.	Bedroom 2 Toilet	9'4" x 7'0"	65
11.	Bedroom 3	12'0" x 14'6"	168
12.	Bedroom 3 Walk-in	7'1" x 7'0"	50
13.	Bedroom 3 Toilet	7'1" x 7'2"	65
14.	Powder Toilet	5'0" x 7'0"	38
15.	Foyer	7'0" x 5'6"	39
16.	Staff Room	7'0" x 10'1"	71
17.	Staff Toilet	4'0" x 5'0"	20
18.	Dining Balcony	11'8" x 4'6"	52
19.	Main Balcony	40'3" x 3'5"	137
20.	Cantilever Balcony	28'0" x 6'7"	183

A.	RERA Carpet Area	1,898 Sq. Ft.
B.	Balconies	422 Sq. Ft.
C.	Total Carpet Area	2,320 Sq. Ft.

## Condos

### Condo F | 3 BHK

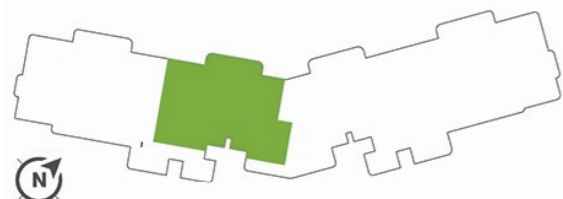

Please Note: The above image is an artist's expression of the floor plan. The areas provided above are approximate, quantifiable by the standard dimension provided.

DIMENSIONS AREA Sq. Ft.

1.	Living Area	28'2" x 16'5"	462
2.	Dining Area	12'0" x 12'9"	153
3.	Kitchen	8'6" x 12'6"	106
4.	Dry Balcony	8'6" x 4'6"	38
5.	Master Bedroom 1	12'0" x 16'5"	196
6.	Master Walk-in	7'0" x 6'8"	46
7.	Master Toilet	7'0" x 9'5"	64
8.	Bedroom 2	12'0" x 16'0"	192
9.	Bedroom 2 Walk-in	8'6" x 7'0"	59
10.	Bedroom 2 Toilet	9'4" x 7'0"	65
11.	Bedroom 3	12'0" x 14'6"	168
12.	Bedroom 3 Walk-in	7'1" x 7'0"	50
13.	Bedroom 3 Toilet	7'1" x 7'2"	65
14.	Powder Toilet	5'0" x 7'0"	38
15.	Foyer	7'0" x 5'6"	39
16.	Staff Room	7'0" x 10'1"	71
17.	Staff Toilet	4'0" x 5'0"	20
18.	Dining Balcony	11'8" x 4'6"	52
19.	Main Balcony	40'3" x 3'5"	137
20.	Cantilever Balcony	28'0 x 6'7"	183

A.	RERA Carpet Area	1,898 Sq. Ft.
B.	Balconies	422 Sq. Ft.
C.	Total Carpet Area	2,320 Sq. Ft.

## Condos

### Condo E | 4 BHK



DIMENSIONS AREA Sq. Ft.

1.	Living Area	29'0" x 22'8"	656
2.	Dining Area	12'8" x 15'6"	196
3.	Kitchen	9'0" x 13'8"	123
4.	Dry Balcony	12'0" x 5'0"	60
5.	Master Bedroom 1	12'10" x 17'7"	224
6.	Master Walk-in	9'0" x 8'0"	72
7.	Master Toilet	9'0" x 9'3"	83
8.	Bedroom 2	18'9" x 13'2"	247
9.	Bedroom 2 Walk-in	6'3" x 6'10"	43
10.	Bedroom 2 Toilet	7'6" x 6'10"	52
11.	Bedroom 3	12'0" x 15'2"	182
12.	Bedroom 3 Toilet	7'0" x 9'8"	66
13.	Bedroom 4	12'0" x 18'4"	220
14.	Bedroom 4 Walk-in	6'0" x 8'2"	49
15.	Bedroom 4 Toilet	6'0" x 10'0"	59
16.	Powder Toilet	6'7" x 4'4"	30
17.	Staff Room	8'9" x 10'9"	94
18.	Staff Toilet	4'6" x 5'0"	22
19.	Foyer	9'0" x 7'0"	63
20.	Dining Balcony	24'9" x 3'5"	85
21.	Main Balcony	54'2" x 3'5"	187
22.	Cantilever Balcony	28'11" x 6'7"	189

A.	RERA Carpet Area	2,703 Sq. Ft.
B.	Balconies	517 Sq. Ft.
C.	Total Carpet Area	3,220 Sq. Ft.

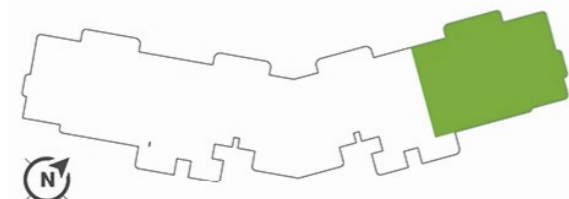

Please Note: The above image is an artist's expression of the floor plan. The areas provided above are approximate, quantifiable by the standard dimension provided.

## Condos

### Condo F | 4 BHK



	DIMENSIONS	AREA Sq. Ft.
1. Living Area	29'0" x 22'8"	656
2. Dining Area	12'8" x 15'6"	196
3. Kitchen	9'0" x 13'8"	123
4. Dry Balcony	12'0" x 5'0"	60
5. Master Bedroom 1	12'10" x 17'7"	224
6. Master Walk-in	9'0" x 8'0"	72
7. Master Toilet	9'0" x 9'3"	83
8. Bedroom 2	18'9" x 13'2"	247
9. Bedroom 2 Walk-in	6'3" x 6'10"	43
10. Bedroom 2 Toilet	7'6" x 6'10"	52
11. Bedroom 3	12'0" x 15'2"	182
12. Bedroom 3 Toilet	7'0" x 9'8"	66
13. Bedroom 4	12'0" x 18'4"	220
14. Bedroom 4 Walk-in	6'0" x 8'2"	49
15. Bedroom 4 Toilet	6'0" x 10'0"	59
16. Powder Toilet	6'7" x 4'4"	30
17. Staff Room	8'9" x 10'9"	94
18. Staff Toilet	4'6" x 5'0"	22
19. Foyer	9'0" x 7'0"	63
20. Dining Balcony	24'9" x 3'5"	85
21. Main Balcony	54'2" x 3'5"	187
22. Cantilever Balcony	28'11" x 6'7"	189
A. RERA Carpet Area	2,703 Sq. Ft.	
B. Balconies	517 Sq. Ft.	
C. Total Carpet Area	3,220 Sq. Ft.	

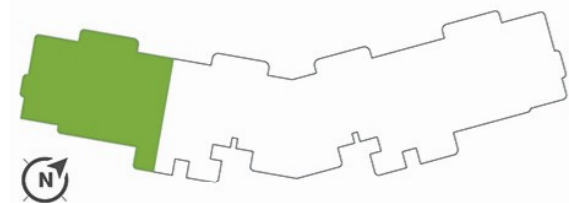

Please Note: The above image is an artist's expression of the floor plan. The areas provided above are approximate, quantifiable by the standard dimension provided.





## Condos

### Condo E | 4 BHK GARDEN

	DIMENSIONS	AREA Sq. Ft.
1. Living Area	29'0" x 22'8"	656
2. Dining Area	12'8" x 15'6"	196
3. Kitchen	9'0" x 13'8"	123
4. Dry Balcony	12'0" x 5'0"	60
5. Master Bedroom 1	12'10" x 17'7"	224
6. Master Walk-in	9'0" x 8'0"	72
7. Master Toilet	9'0" x 9'3"	83
8. Bedroom 2	18'9" x 13'2"	247
9. Bedroom 2 Walk-in	6'3" x 6'10"	43
10. Bedroom 2 Toilet	7'6" x 6'10"	52
11. Bedroom 3	12'0" x 15'2"	182
12. Bedroom 3 Toilet	7'0" x 9'8"	66
13. Bedroom 4	12'0" x 18'4"	220
14. Bedroom 4 Walk-in	6'0" x 8'2"	49
15. Bedroom 4 Toilet	6'0" x 10'0"	59
16. Powder Toilet	6'7" x 4'4"	30
17. Staff Room	8'9" x 10'9"	94
18. Staff Toilet	4'6" x 5'0"	22
19. Foyer	9'0" x 7'0"	63
20. Dining Balcony	24'9" x 3'5"	85
A. RERA Carpet Area	2,703 Sq. Ft.	
B. Balconies	85 Sq. Ft.	
C. Exclusive Garden	1,971 Sq. Ft.	
D. Total Carpet Area	4,729 Sq. Ft.	

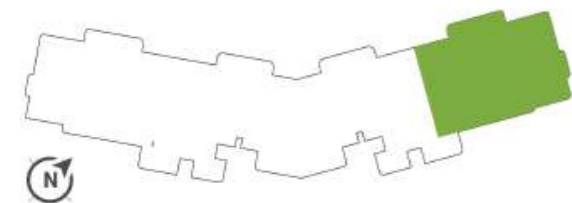

Please Note: The above image is an artist's expression of the floor plan. The areas provided above are approximate, quantifiable by the standard dimension provided.

# Condos

## Condo E | 5 BHK PENTHOUSE LOWER LEVEL



DIMENSIONS AREA Sq. Ft.

1.	Living Area	28'2" x 16'5"	462
2.	Int. Staircase	12'0" x 12'9"	153
3.	Kitchen	8'6" x 12'6"	106
4.	Dry Balcony	8'6" x 4'6"	38
5.	Master Bedroom 1	12'0" x 16'0"	192
6.	Master Walk-in	8'6" x 7'0"	59
7.	Master Toilet	9'4" x 7'0"	65
8.	Bedroom 2	12'0" x 14'6"	168
9.	Bedroom 2 Walk-in	7'1" x 7'0"	50
10.	Bedroom 2 Toilet	7'1" x 7'2"	65
11.	Bedroom 3	12'0" x 16'5"	196
12.	Bedroom 3 Walk-in	7'0" x 6'8"	46
13.	Bedroom 3 Toilet	7'0" x 9'5"	64
14.	Powder Toilet	5'0" x 7'0"	38
15.	Foyer	7'0" x 5'6"	39
16.	Staff Room	7'0" x 10'1"	71
17.	Staff Toilet	4'0" x 5'0"	20
18.	Dining Balcony	11'8" x 4'6"	52
19.	Main Balcony	40'3" x 3'5"	137
20.	Cantilever Balcony	28'0" x 6'7"	183

A.	RERA Carpet Area	1,898 Sq. Ft.
B.	Balconies	422 Sq. Ft.
C.	Total Carpet Area (Lower)	2,320 Sq. Ft.

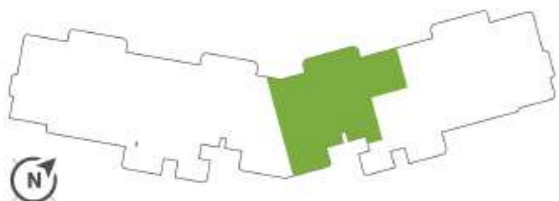

Please Note: The above image is an artist's expression of the floor plan. The areas provided above are approximate, quantifiable by the standard dimension provided.

# Condos

## Condo E | 5 BHK PENTHOUSE UPPER LEVEL

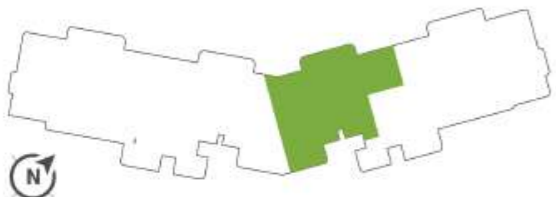

Please Note: The above image is an artist's expression of the floor plan. The areas provided above are approximate, quantifiable by the standard dimension provided.

	DIMENSIONS	AREA Sq. Ft.
1. Bedroom 4	12'0" x 16'0"	192
2. Bedroom 4 Walk-in	8'6" x 7'0"	65
3. Bedroom 4 Toilet	12'0" x 7'0"	59
4. Bedroom 5	12'0" x 14'6"	174
5. Bedroom 5 Walk-in	7'1" x 7'0"	50
6. Bedroom 5 Toilet	7'1" x 7'2"	51

A. RERA Carpet Area	882 Sq. Ft.
B. Exclusive Terrace	1,080 Sq. Ft.
C. Total Carpet Area (Upper)	1,962 Sq. Ft.

A. RERA Carpet Area	2,780 Sq. Ft.
B. Exclusive Terrace	1,080 Sq. Ft.
C. Balconies	422 Sq. Ft.
D. Total Carpet Area (Upper+ Lower)	4,282 Sq. Ft.

## Condos

### Condo F | 6 BHK PENTHOUSE LOWER LEVEL



DIMENSIONS AREA Sq. Ft.

1.	Living Area	29'0" x 22'8"	656
2.	Int. Staircase	12'8" x 15'6"	196
3.	Kitchen	9'0" x 13'8"	123
4.	Dry Balcony	12'0" x 5'0"	60
5.	Master Bedroom 1	12'10" x 17'7"	224
6.	Master Walk-in	9'0" x 8'0"	72
7.	Master Toilet	9'0" x 9'3"	83
8.	Bedroom 2	18'9" x 13'2"	247
9.	Bedroom 2 Walk-in	6'3" x 6'10"	43
10.	Bedroom 2 Toilet	7'6" x 6'10"	52
11.	Bedroom 3	12'0" x 15'2"	182
12.	Bedroom 3 Toilet	7'0" x 9'8"	66
13.	Bedroom 4	12'0" x 18'4"	220
14.	Bedroom 4 Walk-in	6'0" x 8'2"	49
15.	Bedroom 4 Toilet	6'0" x 10'0"	59
16.	Powder Toilet	6'7" x 4'4"	30
17.	Staff Room	8'9" x 10'9"	94
18.	Staff Toilet	4'6" x 5'0"	22
19.	Foyer	9'0" x 7'0"	63
20.	Dining Balcony	24'9" x 3'5"	85
21.	Main Balcony	54'2" x 3'5"	187
22.	Cantilever Balcony	28'11" x 6'7"	189

A.	RERA Carpet Area	2,792 Sq. Ft.
B.	Balconies	430 Sq. Ft.
C.	Total Carpet Area (Lower)	3,222 Sq. Ft.

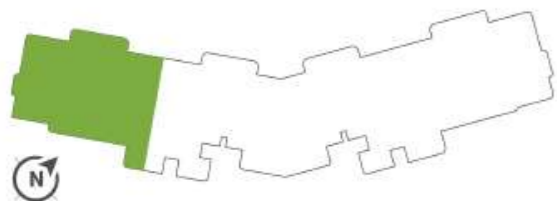

Please Note: The above image is an artist's expression of the floor plan. The areas provided above are approximate, quantifiable by the standard dimension provided.

# Condos

## Condo F | 6 BHK PENTHOUSE UPPER LEVEL



	DIMENSIONS	AREA Sq. Ft.
1. Bedroom 5	12'0" x 22'8"	256
2. Bedroom 5 Walk-in	6'0" x 11'0"	65
3. Bedroom 5 Toilet	6'0" x 11'4"	67
4. Bedroom 6	12'0" x 19'1"	230
5. Bedroom 6 Walk-in	5'11" x 9'5"	56
6. Bedroom 6 Toilet	4'6" x 9'5"	48

A. RERA Carpet Area	958 Sq. Ft.
B. Exclusive Terrace	1,785 Sq. Ft.
C. Total Carpet Area (Upper)	2,743 Sq. Ft.

A. RERA Carpet Area	3,750 Sq. Ft.
B. Exclusive Terrace	1,785 Sq. Ft.
C. Balconies	430 Sq. Ft.
D. Total Carpet Area (Upper+ Lower)	5,965 Sq. Ft.

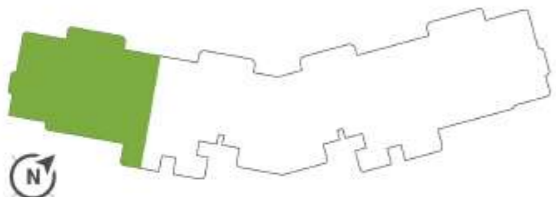

Please Note: The above image is an artist's expression of the floor plan. The areas provided above are approximate, quantifiable by the standard dimension provided.



# INNER CIRCLE

Saral, Alibaug

MahaRERA Registration  
P52000056043

[info@innercirclealibaug.com](mailto:info@innercirclealibaug.com)  
+91 9619555900  
[www.innercirclealibaug.com](http://www.innercirclealibaug.com)

